

Monitor Overview

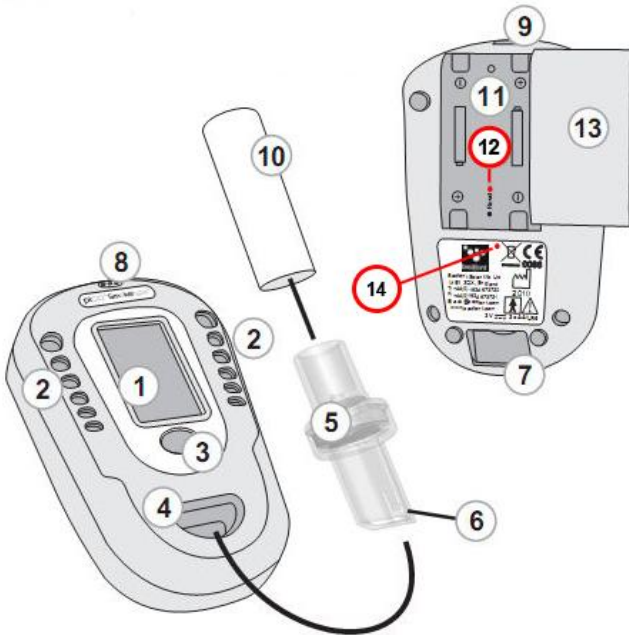



1. Display
2. Colored LEDs
3. Button – ON/OFF & Navigation
4. D-Piece Opening
5. D-Piece
6. Lug on D-Piece
7. Exhaust Port
8. Sounder
9. USB Connector
10. Mouthpiece
11. Battery Compartment
12. **Reset Button** - Contact coVita for details
13. Battery Cover
14. **Vent Hole** – DO NOT COVER WITH LABELS

Storage

1. **Never use or store** your monitor around **alcohol** based products. This includes, but not limited to; using **alcohol** based hand sanitizers with or without gloves, monitor storage in the vicinity of containers of alcohol based hand sanitizers. The sensor in the monitor will absorb these vapors and affect it negatively.
Solution: Place the monitor in a fresh air room with the D-piece removed. Allow for 24-48 hours for the sensor to stabilize and clear out.
2. Be aware that your monitor is *sensitive* to vapors from **VOCs** (Volatile Organic Compounds) such as *alcohol based hand sanitizers and wipes, fresh paint, fumes from solvents*. Be aware of the environment that you are using your monitor in. Prolonged exposure to vapors or fumes of any kind may impact your monitor. Remove it from adverse situations.
3. **Always** store monitor in its carrying case in a safe, temperature controlled environment (70° F).
Tip: For an added layer of protection or when transporting, store your monitor in a household Ziploc storage bag before placing into canvas carrying bag.
4. **Avoid** exposing monitor to extreme temperatures, i.e. below 32°F or above 100°F. **Avoid** humidity as much as possible. **Do not** leave your monitor in a hot vehicle for any period of time.
5. If you do not plan on using your monitor within **30 days**, please remove batteries as batteries can develop acid leaks which can damage electronic equipment.

Use

1. With newer monitors, you will not see the  "zeroing symbol" in the calibration menu, your monitor *auto zeros* every time you turn it on.

Note: With older monitors, use your monitor's  "zeroing" option whenever you enter a new environment. This feature can be found under the  calibration symbol on your monitor. Please refer to your instruction manual *Contact coVita to learn of any available firmware upgrades or trade in credits towards a new monitor.*

2. **Change** your *D-piece* every 30 days. You cannot clean the *D-piece* and do not attempt to clean it with water or cleansers as it will damage the flutter valve which will compromise the one-way nature of the valve. Please review the *Infection Control Guide* at www.covita.net
3. **Calibrate** every 6 months to correct for sensor drift using 20 ppm Carbon Monoxide (CO) calibration gas.
4. **Never** block the *air/vent hole* on the Smokerlyzer[®] with labels.
5. Always remove the *D-piece* between tests, even if it's only for a few seconds. This allows fresh air to pass over the sensor and clear the previous reading much faster.

Infection Control



NEVER USE cleansing products containing **alcohol** or other cleaning agents or solvents around your monitor. This includes using it on your hands prior to using the monitor. coVita | Bedfont offers **alcohol-free** cleansing wipes which are specifically engineered for use on coVita | Bedfont monitors and accessories. Effective against 99.999% of Germs, Spores, Bacteria, and Fungi. Tested against H5N1 Avian Flu and H1N1 Swine Flu. Additionally, coVita | Bedfont offers a hand sanitizer which was designed to safely and gently cleanse your hands. Because it's engineered to be alcohol-free, it won't interfere with your monitor's sensor or accessories. Kills 99.99% of germs, bacteria, & fungi without drying your skin. Best practice is to wipe your monitor down with a wipe once per day after a day's use or at your discretion. Please refer to the *Infection Control Guide*.



coVita | Bedfont is proud to have the world's first line of anti-bacterial CO monitors. Integrated into the dark blue surface of your piCO+ is a patented ionic silver additive called SteriTouch[®]. This range of antimicrobial additives is designed to reduce the growth of harmful organisms such as bacteria, mold and fungi. SteriTouch[®] is particularly effective against illness causing bacteria such as MRSA, E. Coli and Salmonella. Even with Steritouch, a best practice is to wipe your monitor down with a wipe once per day after a day's use or at your discretion. Please refer to the *Infection Control Guide*.